

TECHNICAL SPECIFICATION

WD WD WD
04 05 06



FRONT ELEVATION

SIDE ELEVATION

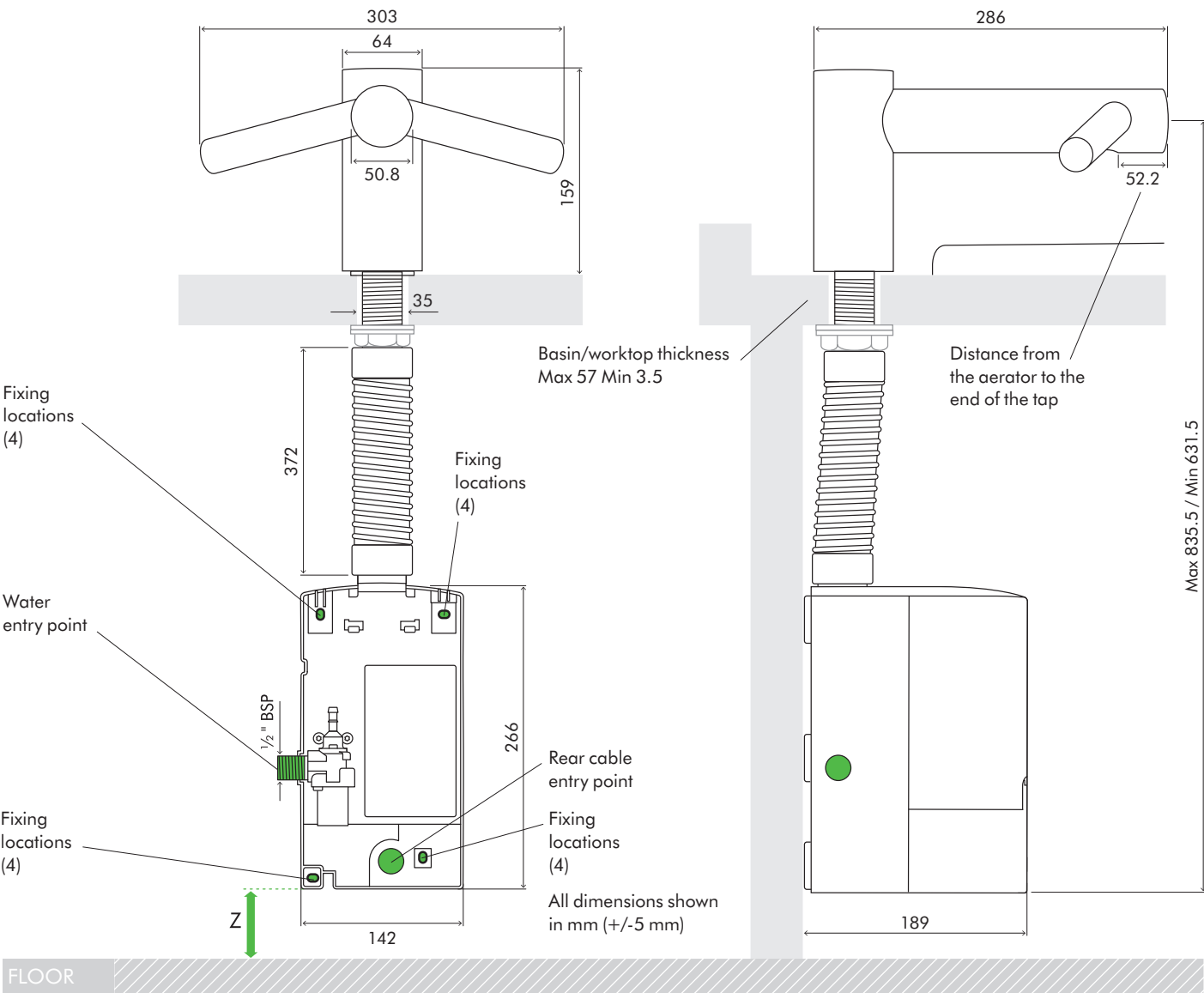

Tap dimensions

WD04 Height 159 mm Width 303 mm Depth 286 mm

Motor bucket dimensions

WD04 Height 266 mm Width 142 mm Depth 189 mm

Minimum clearance

Z 100 mm clearance from floor

TECHNICAL SPECIFICATION

WD WD WD
04 05 06



Tall

FRONT ELEVATION

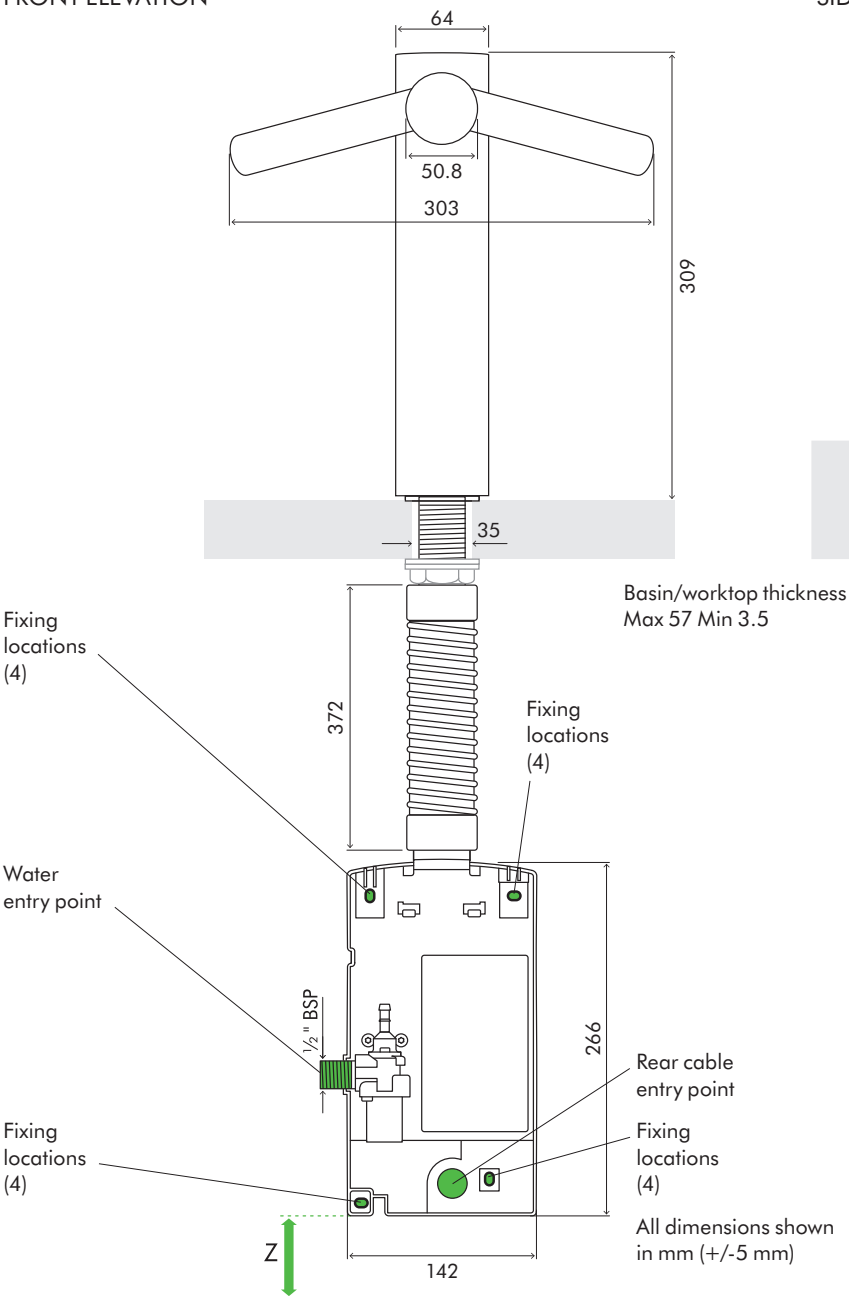

Fixing locations (4)

Water entry point

Fixing locations (4)

Basin/worktop thickness
Max 57 Min 3.5

Fixing locations (4)

Rear cable entry point

Fixing locations (4)

All dimensions shown in mm (+/-5 mm)

FLOOR

Tap dimensions

WD05 Height 309 mm Width 303 mm Depth 286 mm

Motor bucket dimensions

WD05 Height 266 mm Width 142 mm Depth 189 mm

SIDE ELEVATION

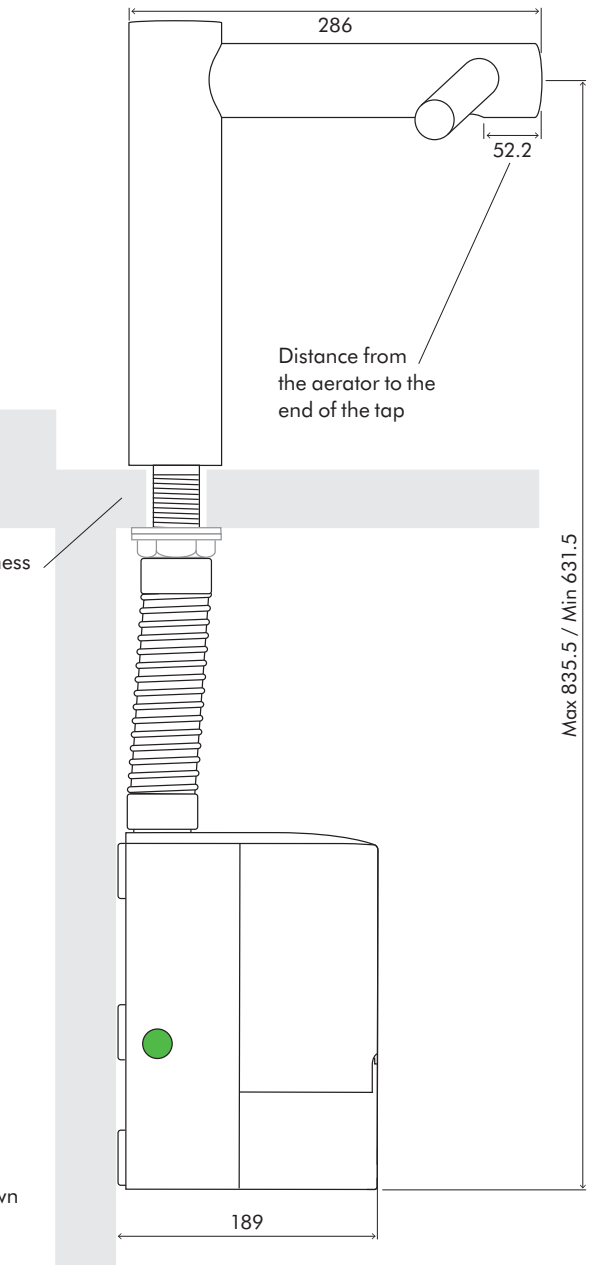

Distance from the aerator to the end of the tap

Max 835.5 / Min 631.5

Minimum clearance

Z 100 mm clearance from floor

TECHNICAL SPECIFICATION

WD WD WD
04 05 06



WD06 Wall installation

The Dyson Airblade Wash+Dry hand dryer is designed so that the motor unit is located behind the stud wall within a metal enclosure which is supplied with the Dyson Airblade Wash+Dry hand dryer (Fig.1). The vertical wall studs must be constructed so as to allow the metal enclosure to be fitted between them (Fig.2). One of the horizontal wall studs must be fitted a) so it holds the main weight of the metal duct and the unit, and b) so it is in the correct position for the tap stem.

For complete instructions, please refer to the printed installation guide supplied with the machine.

It's also available online at www.dyson.co.nz/hand-dryers/useful-documents

Fig.1



Fig.2

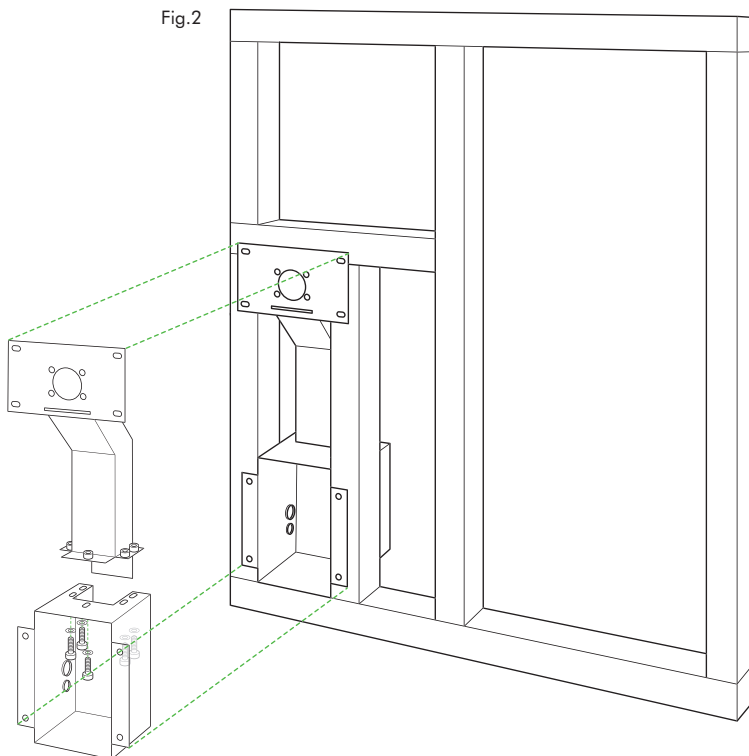

Fig.3

Install plasterboard.

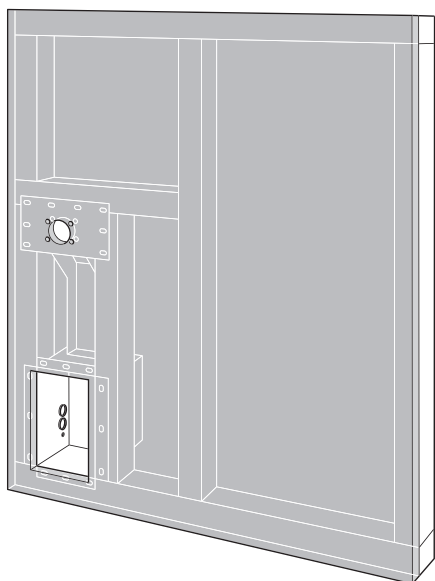
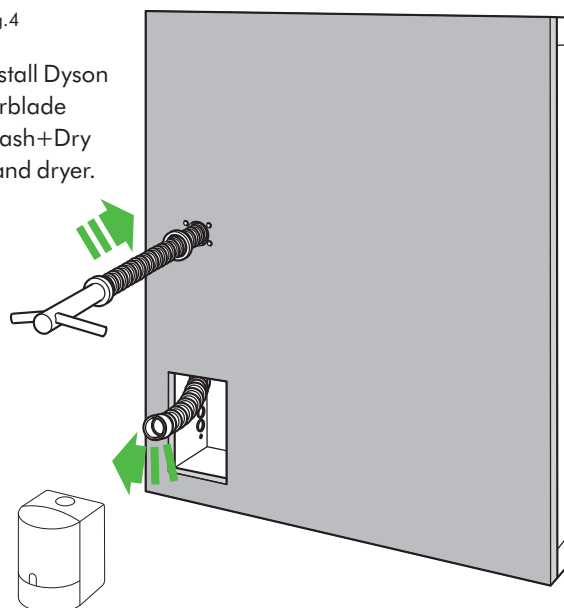

Fig.4

Install Dyson Airblade Wash+Dry hand dryer.



TECHNICAL SPECIFICATION



Electrical
Input voltage/Frequency: 200-240V 50-60Hz
Motor specification: 1000W digital brushless motor
Operating temperature range: 0°-40°C
Heater type: None
Standby power consumption: Less than 0.5 W
Construction
Tap construction: Stainless steel (brushed)
Under counter motor assembly construction: Moulded ABS (main unit)
Exterior screw type: Torx T15
Water ingress protection to IP35
Filter
HEPA filter (glass fibre and fleece prelayer)
Captures 99.95% of particles the size of bacteria from the washroom air ¹
Operation
Touch-free infra-red activation
Hand dry time measurement: 14 seconds
Operation lock-out period: 30 seconds
Airspeed at apertures: 549 km/h
Maximum altitude: 2,000 metres
Water operation
Water flow rate: 1.9 l/min normal fitted aerator. 4 l/min with low flow aerator supplied with product.
Water temperature control: Thermostatic mixer recommended (not supplied)
Water pressure required: 100-800 kPa
Equipped with automatic duty flush – every 24 hours for 60 seconds after the last use.
Logistics
Net weight: WD04 4.26 kg; WD05 4.54 kg; WD06 9.51 kg
Packaged weight: WD04 6.76 kg; WD05 7.38 kg; WD06 13.65 kg
Packaged dimensions: WD04 H303 × W284 × D291 mm WD05 H434 × W275 × D288 mm; WD06 H610 × W375 × D302 mm

Basin specification
The Dyson Airblade Wash+Dry hand dryer is compatible with most basin types. Ensure plugs are not installed in the basins and avoid inserts with embedded plugs (e.g. ones that swivel or elevate).
Using a specially designed test method, Dyson engineers evaluated the user experience of a wide range of basin types when used with the Dyson Airblade Wash+Dry hand dryer. For further details on our recommended basins, please contact Dyson.
We recommend avoiding basins with the following geometric characteristics; Flat bases immediately surrounding the drain hole. (nominally within a 60 mm radius). Sloping back and front wall transitions in relation to the base of the basin. See our pre-installation guide for further details: www.dyson.co.nz/hand-dryers/useful-documents
Basin dimensions: All basin measurements are internal unless stated otherwise. Minimum width of basin: 350 mm, Front to back – Minimum: 300 mm Minimum depth of basin: 100 mm Maximum depth of basin for WD05 only: 200 mm (External measurement of vessel basin)
Basin materials: Basins with highly polished surfaces should be avoided, e.g. reflective chrome. Porcelain or brushed metal is ideal. When multiple taps are installed side-by-side, tap centres should be a minimum of 580 mm apart.
Standard guarantee
5 year parts, 5 year labour.

Product range		
WD04 Short	WD05 Tall	WD06 Wall
		