

Conti Flamingo Infrared Hob Basin Tap Single Temperature - Battery Operated

Specification Data Sheet



Features

- Single Temperature.
- Double Infrared Sensor with Automatic Setting Feature and Microprocessor.
- Bi-Stable Magnetic Solenoid Valve (for increased energy saving).
- Water Supply Connection with Flexible High Pressure Hose and Strainer.
- 6V Lithium CR-P2 commercial battery included.
- Iqua touch feature enables temporary - off (for cleaning purposes) or continuous water flow (for filling the basin).
- Appropriate Mounting Hardware included.
- Check valve and built in strainer.
- 12 or 24 or 72 hour hygienic rinse activatable.

To Specify

Conti Flamingo chrome plated electronic tapware is ideal for any hand washing stations that call for the convenience of automatic activation with the option of user-controlled settings.

Code:

TZ-FL20SB – Conti Flamingo Infrared Hob Basin Tap with Single Temperature - Battery Operated

Hands Free Hygiene

Ph: 1800 039 764

sales@handsfreehygiene.com.au

handsfreehygiene.com.au

hands free hygiene
clean hands, safe hands

Performance Standards & Approvals

- AS/NZS 3718 - WaterMark
- WELS 6 Star Rating



This tap not only passes the Australian Standard testing for potable water (AS/NZS 4020), it also complies with s1417 of the Safe Drinking Water Act in the USA and complies with NSF61 / NSF372. Therefore, in the USA this tap can be labelled as 'lead free'. In addition, all metallic materials used in this tap are listed on the European Standard (4MS Common Approach), which ensures they meet the strict German Drinking Water Guidelines.

Typical Dimensions

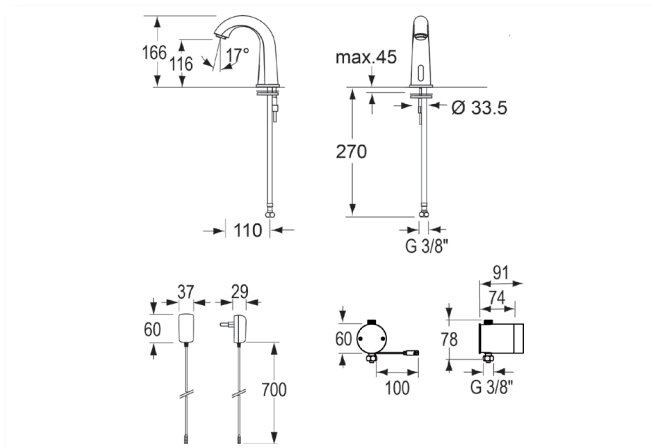

Technical Information

- Operating pressure: 30kPa - 500kPa
- Maximum water temperature: 80°C
- Aerator: Economy aerator, cascade (self-cleaning)
- Inlet Connection: Flexible hose at 350mm long
- Strainer: 0.5mm mesh size
- Sensor-sensitivity: Automatic self-adapting sensor
- Sensor range nominal: 102mm - 127mm
- Hygienic rinse time: 2 minutes pre-set (adjustable from 0.5 - 20 minutes)
- Engineering standards: Noise class I, DIN EN 200; P-IX 9576 / IA

Operation

As the user's hands enter the beam's effective range, the beam is reflected back into the sensor receiver and activates the solenoid valve allowing water to flow from the tap. Water will flow until the hands are removed or until the tap reaches its automatic time out limit setting.

Maintenance & Cleaning

Galvin Specialised products should be cleaned with a soft damp cloth using only mild liquid detergent or soap and water. Do not use cleaning agents containing a corrosive acid, scouring agent or solvents. Do not use cream cleaners, as they are abrasive. Use of unsuitable cleaning agents may damage the surface. Any damage caused in this way will not be covered by warranty.

Regular maintenance should be carried out in accordance with the installation and troubleshooting guides provided with the product, relevant Australian Standards, local authorities and state codes.

As part of maintaining a safe and reliable plumbing system, we recommend tapware and valves are operated on at least a daily basis.

Hands Free Hygiene

Ph: 1800 039 764

sales@handsfreehygiene.com.au

handsfreehygiene.com.au

